

Calex Circum BCL320

Description:

It adopts high brightness high quality LED as luminous body with low -voltage constant current driver, low power consumption, long lifespan, reliability and safety.

The lamp body is made of high-quality steel plate in one piece. The housing, which is elegant and stylish, is made of polystyrene with high-light transmittance. The special material guarantees that the color will never fade away.

The excellent design in heat dissipation ensures stable working of LED, and controls light attenuation effectively. Perfect optical design ensures soft and even light. Instant lighting, no flickering, no glaring. Free of lead, mercury and other harmful substances.

This product is widely used in shopping mall, hotel, restaurant and etc. It's an ideal replacement of traditional ceiling light products.

Notes:

- ◆ Only qualified electrician is allowed to do the installation, maintenance and inspection for safety concern. It is dangerous for non-professional operator
- ◆ Surface mounted installation only
- ◆ Do not install the product in high temperature or humid place

Installation Method:

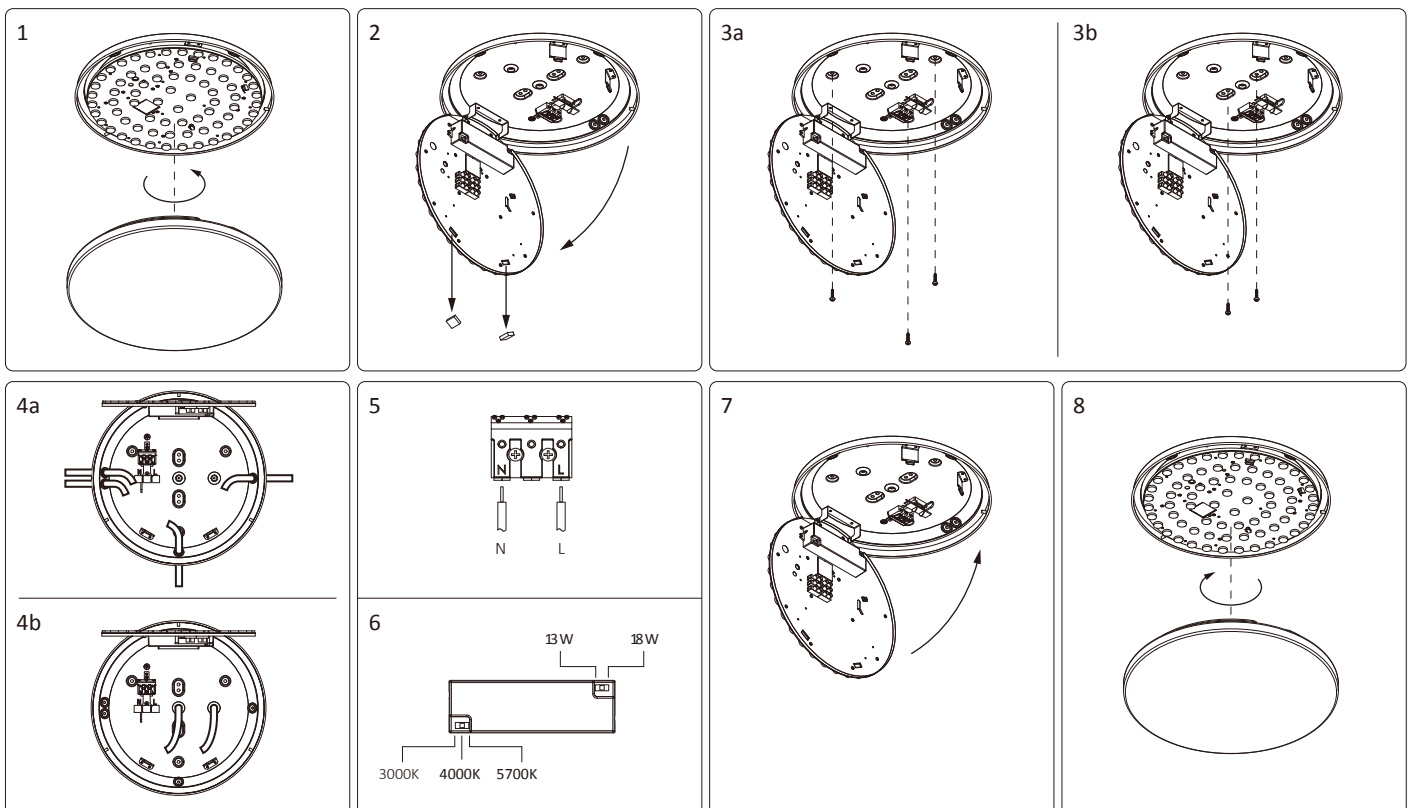

Technical Parameters:

Part No	Calex Circum BCL320	
Input Voltage(VAC)	220-240V AC	
Input Current(A)	0.095	0.13
Power(W)	13W	18W
Power Factor	0.9	
Color Temperature(K)	3000K/4000K/5700K	
Luminous Flux (Lm)	1400/1550/1500	1900/2100/2000
Lifespan (hour)	100000	
Protection Rate	IP54	
Working Temperature(°C)	-20~40	
CRI (Ra)	>80	

Dimensions:

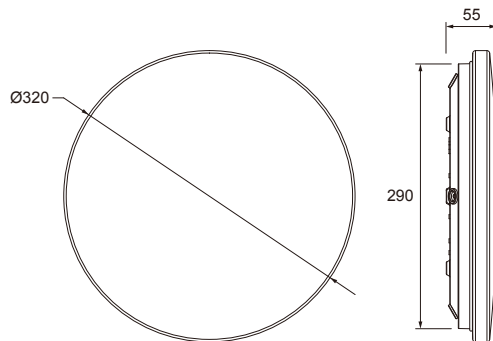

WARNING



- * Power should be cut off before installation, maintenance or inspection.
- * Please install and use the light strictly according to the instruction.
- * Do not disassemble or remold the product at will to avoid accident of electric shock or light falling.
- * For non-user replaceable light sources: "The light source contained in this luminaire shall only be replaced by the manufacturer or his service agent or a similar qualified person."
- *The symbol of the crossed out wheeled bin indicates that product(electrical and electronic equipment) should not be placed in municipal waste. Please check local regulations for disposal of electronic products
- *The luminaire needs to be configured by the qualified person.",The cross-sectional area of the power cord shall be at least 0.75 mm² ; for indoor use only.